

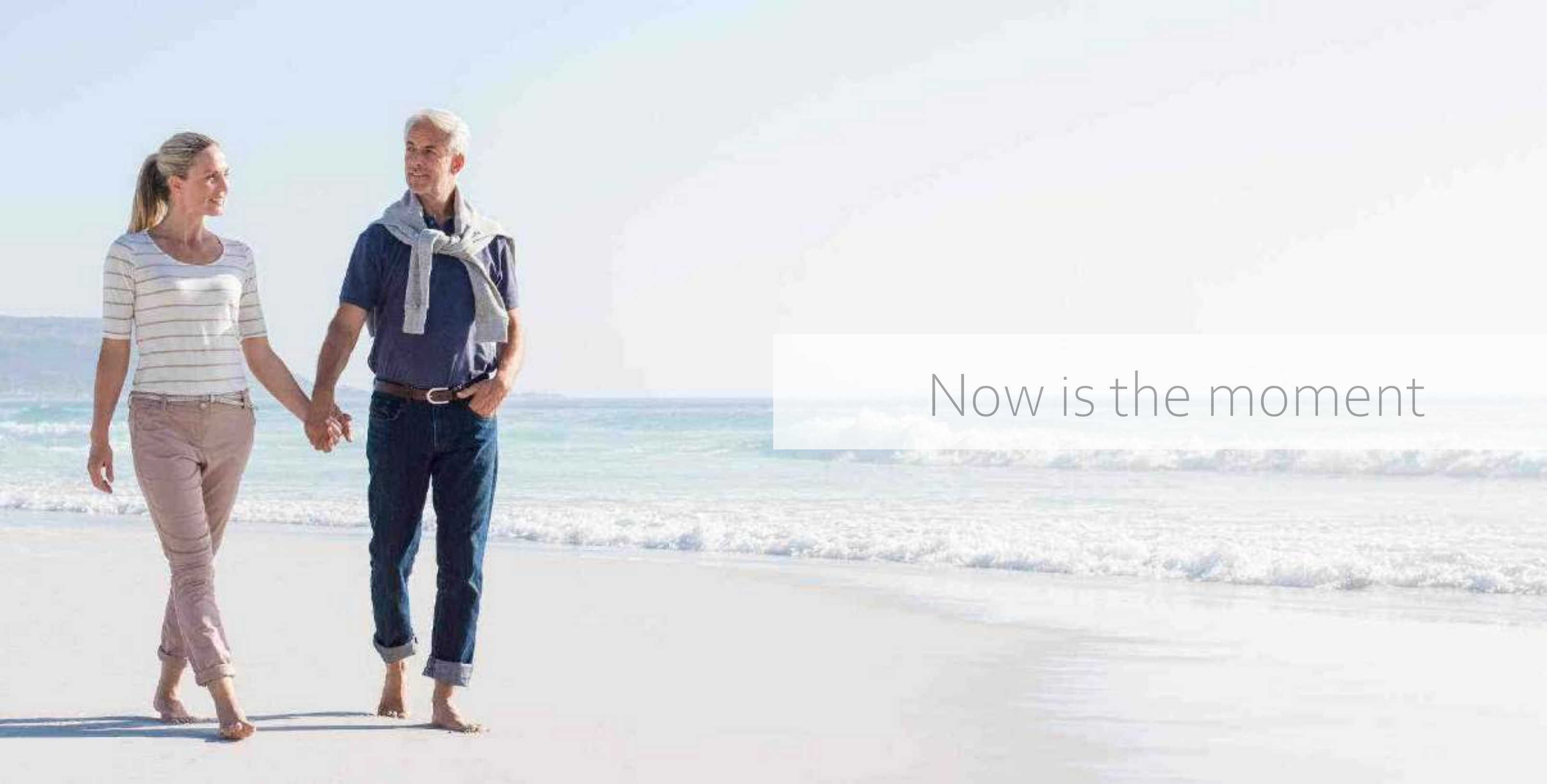

SKYLINE **4** RESIDENTIAL



Now is the moment



# Rojales

Costa Blanca

Have you finally decided to live in Spain? That's great news! We cannot do other than congratulate you. In Rojales? Of course. A traditional Spanish town where you will be able to find everything you need in order to have a happy life. Because there is always something to do here: enjoying beautiful evenings; playing golf; shopping at a Spanish market; going on a bike ride along the beach or at the splendid lagoons; going shopping to Zenia Boulevard or just enjoying a beer or a coffee at the hundreds of different terraces that Rojales can offer. Sun and relax, sun and relax. That is the motto. Do you dare?







# *La Marquesa* GOLF

La Marquesa Golf is one of the most historic courses on the Costa Blanca, with 18 holes and one as special as the 17th hole at Sawgrass. Tradition, quality and experience come together to offer golfers who visit us a unique experience, full of history where, in addition, Miguel Ángel Jiménez is our honorary member.







Skyline Residential IV is a wonderful, luxurious and great house complex... I could keep going, but you already know it. Because in the end... everyone says the same. But, what is so special about our houses? Firstly, our company does everything, from building them to sell them. We are responsible of the 100% of the process. Secondly, there are no companies which have

an after-sales service as effective as ours. We not only accompany you during the selling process but we are also with you afterwards, as much as you want. Finally, we know that you all don't want the same, so we help you to personalise and adapt the houses to your own needs. Because if someone wants pink walls and 8 bathrooms, we'll help you choose the taps. :)







2 minutes. Distance to La Marquesa Golf.



10 minutes. Guardamar beaches.



Average annual temperature.



320 Sunny days a year.



35 minutes. Alicante airport.



40 minutes. Murcia airport.









Ground Floor



First Floor



Basement

Ground Floor	88,00 m <sup>2</sup>
First Floor	43,70 m <sup>2</sup>
Basement	146,00 m <sup>2</sup>
<b>TOTAL BUILT</b>	<b>277,70 m<sup>2</sup></b>

Costa  
Skyline IV









Electrical appliances



Air conditioning machines



Infinity swimming pool



Luminaries

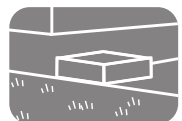

Garden architecture

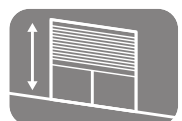

Motorized blinds



Walk-in closets



Ground Floor



Basement

Ground Floor	79,50 m <sup>2</sup>
Basement	123,00 m <sup>2</sup>
<b>TOTAL BUILT</b>	<b>202,50 m<sup>2</sup></b>

Skylina IV **Blanca**







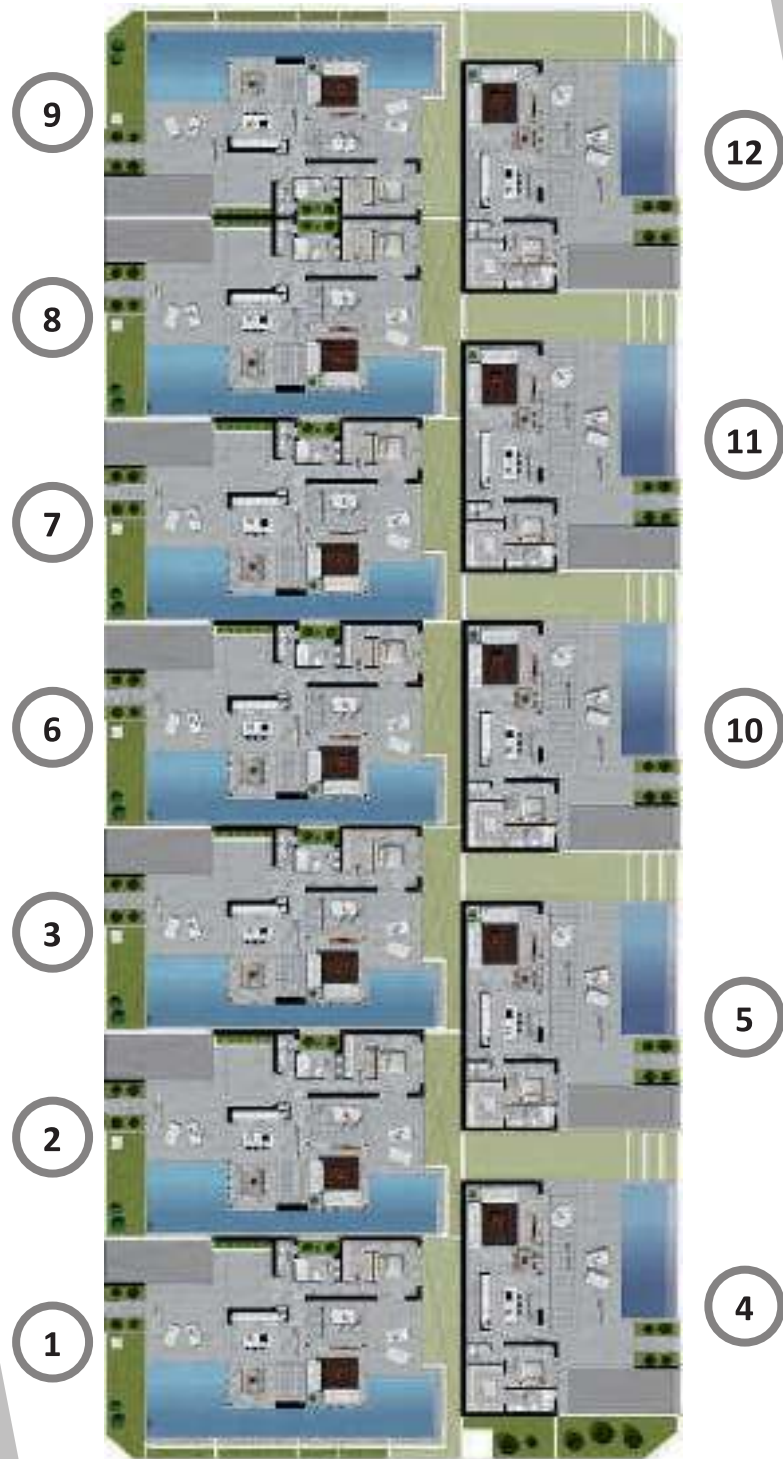





SKYLINE 4 RESIDENTIAL